

Esme Timbery Creative Practice Lab

Studio One

Technical Specifications

As of 2025

Please Note: These Technical Specifications are subject to change.

Please confirm all details with the Creative Practice Lab

General

Studio One is managed by the Creative Practice Lab, part of the School of the Arts and Media at the University of New South Wales. It is a purpose-built performance space opened in 2019. There are two performance spaces in the Esme Timbery Creative Practice Lab – the larger Io Myers and Studio One, an intimate Black Box Space.

Contacts

School general		sam@unsw.edu.au
Mark Mitchell	Production Manager	m.mitchell@unsw.edu.au
Troy Reid	Production Assistant	troy.reid@unsw.edu.au

Access

Loading Access to Studio One is limited. The loading dock, on Union Road is shared with Io Myers and other facilities. Access from the loading dock is through corridors and a goods lift, involving several tight 90-degree corners and going through student common areas.

The goods lift door is 1600(w) x 2400(h). The lift is 1800(w) x by 2250(d). The smallest door between the dock and theatre is 1500(w) x 2100(h).

Access to the Loading Dock needs to be arranged in advance with the Production Manager.

General access is through the main entry on First Ave East, and down the stairs to your left or the lift. There is no stage door. There is a no stopping zone outside this entry.

Parking is limited at the University, there are no dedicated parking spots for the Studios, and it is not possible to leave vehicles in the loading dock.

Vehicle access to the loading dock is From Gate 2 on High Street.

Dressing Rooms

Studio One has one dedicated dressing room, suitable for approximately 10 people. There are also showers and toilets, including accessible ones, available. Toilets and showers are shared with Io Myers.

Wi-Fi and Mobile

Currently, there is no mobile reception in any part of Studio One.

Wi-Fi is available to UNSW students and staff on the 'eduroam' network.

Guest Wi-Fi is available on the 'UNSW Guest' network once you're on campus, this requires a simple registration process with an email address.

Technical

Lighting

Studio One has a fixed grid with patching distributed throughout. Dimmers and patching are located in a cupboard in the Studio One Foyer.

Control

ETC Element 60

3 x LSC Redback Dimmer Racks (Total 36 x 1.2KW channels)

Fixtures

14 x Acclaim 22-40 Profiles. Colour frames 125mm square. M size Gobos, 66mm diameter.

12 x ProLights EclFresnel CT+S (with barndoors), 9 - 70 degree with 6 colour LEDs source.

8 x ETC Colorsourc Par. Wide, round field lenses, 70 degree.

Studio One has a reasonable stock of DMX and 240V Cables.

Additional

Additional equipment, including lighting booms, a mirror ball and hazers may be available. Please confirm any requirements and additional costs with the Production Manager.

Sound

The standard setup for Studio One is a L-R arrangement with speakers hung on the upstage bar.

FOH

Allen & Heath SQ6 48 Channel mixing desk

4 x QSC K8.2 Speakers

1 x Mackie SWA1501 Sub

Additional Equipment

Additional equipment, including monitors, microphones and a stage box may be available. Please confirm any requirements and additional costs with the Production Manager.

NB. Please note that Studio One is not suitable for close, critical audio recording as we have noise from air-conditioning units, noise from corridors and possibly noise from neighbouring Io Myers Studio

AV

A range of projectors and screens may be available. Please confirm any requirements and additional costs with the Production Manager.

Seating Bank

The seating bank for Studio One is made of 1m x 2m rostra on 3 levels, with a fourth row of seats in front, and can fit a total of 57 seats. As a rule, there can be no more than 8 seats away from an aisle. It is possible for the seating bank to be removed or rearranged, however it must be returned to the standard arrangement as part of bump out.

For more information, please contact the Production Manager.

Emergency Egress

There are two doors located along the backstage corridor. Generally, it is acceptable for one of these doors to be blocked by set or the seating bank. The other door must be completely unobstructed and have a clear path to it. The exit sign on the obstructed door must be covered. Both doors into the foyer areas must be unobstructed.

For more information, please contact the Production Manager. If any doors are obstructed, this must be approved by the Production Manager.

Rigging

All rigging in Studio One must be carried out by a licensed rigger. The Studio One grid's maximum distributed load is 50kg/m.

For more information please contact the Production Manager.

Stage Floor and Walls

The stage floor is black painted Masonite. It is permitted to screw and attach to the floor. The Stage may be painted (with water-based paints) but must be restored to black as part of the bump out.

The Backstage Corridor Wall is also able to be painted, so long as the power points, blue lights and patch points are covered. This must also be painted back to black during the bump out.

Paint for repainting will be provided at cost.

The studio has two black wool tabs 3.3m high x 6m wide and six black wool legs 3.5m high x 1.2m wide.

Show Relay and Paging

There is a show relay in the dressing rooms and common areas, as well as a paging mic, normally located at the bio box.

These can only be controlled or reassigned from the Io Myers Studio AV Room, so are not accessible to Studio One users and will have to be controlled by the Production Manager.

Studio One has a Jands Ezi-com system comprising of one master station, four belt packs and five headsets.

Power

Technical Earth GPOs (Green) are located around the theatre

1 x 32 Amp 3 Phase is located in the bio box area of the theatre and there is an additional 32 Amp 3 Phase located in the dimmer rack (total of 4).

Health and Safety

All performers and crew will be required to complete a safety induction before commencing work in the theatre. This can be completed online before arriving or by an authorised staff member in person.

Risk Assessments may need to be supplied. Safety Data Sheets (SDS) will need to be supplied for anything brought onsite.

Please confirm all safety requirements or concerns with the Production Manager.

Plans

A general plan of the theatre follows. A full set of plans is available at:

<https://www.arts.unsw.edu.au/sam/creative-practice/esme-timbery-creative-practice-lab/venues-hire>

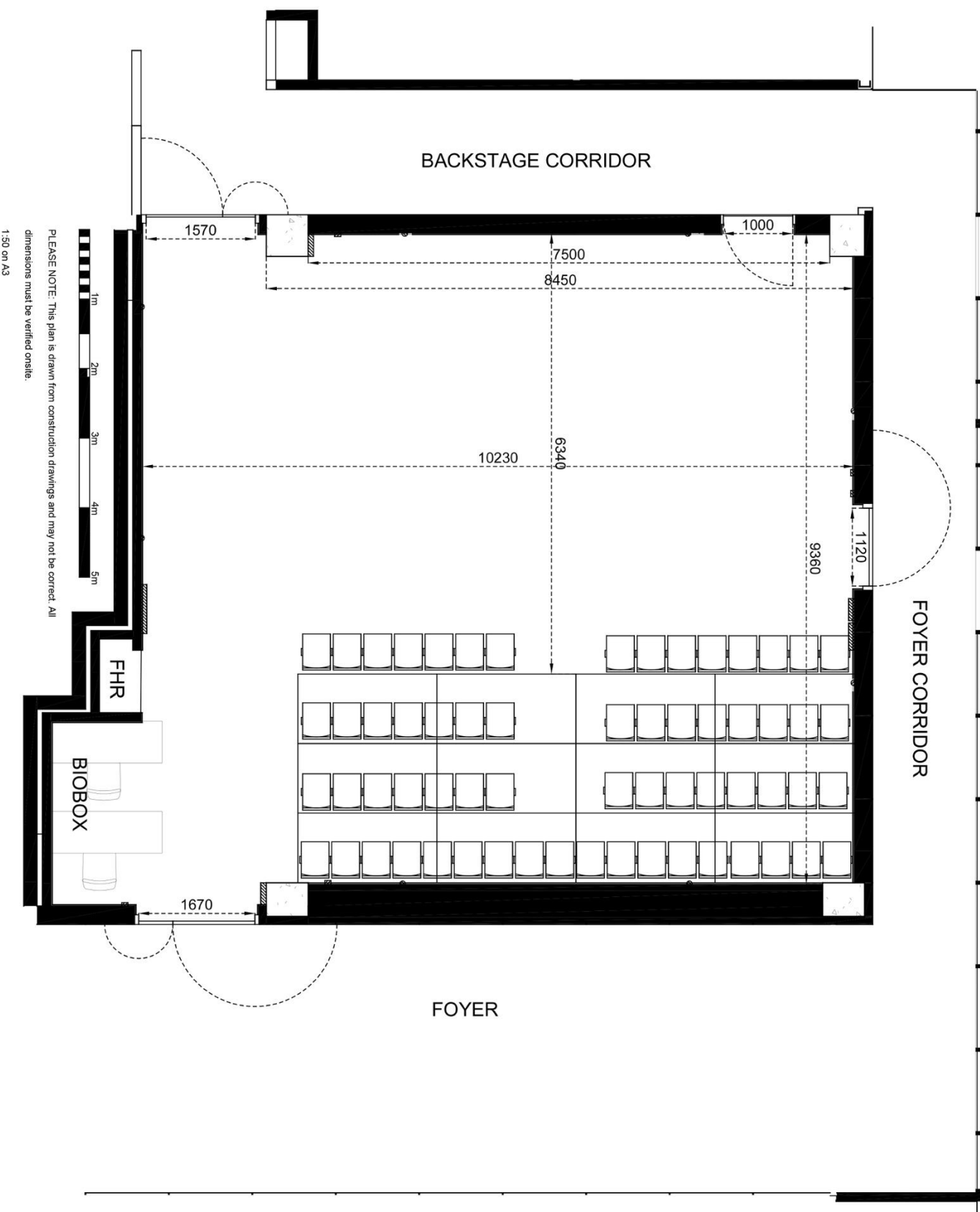

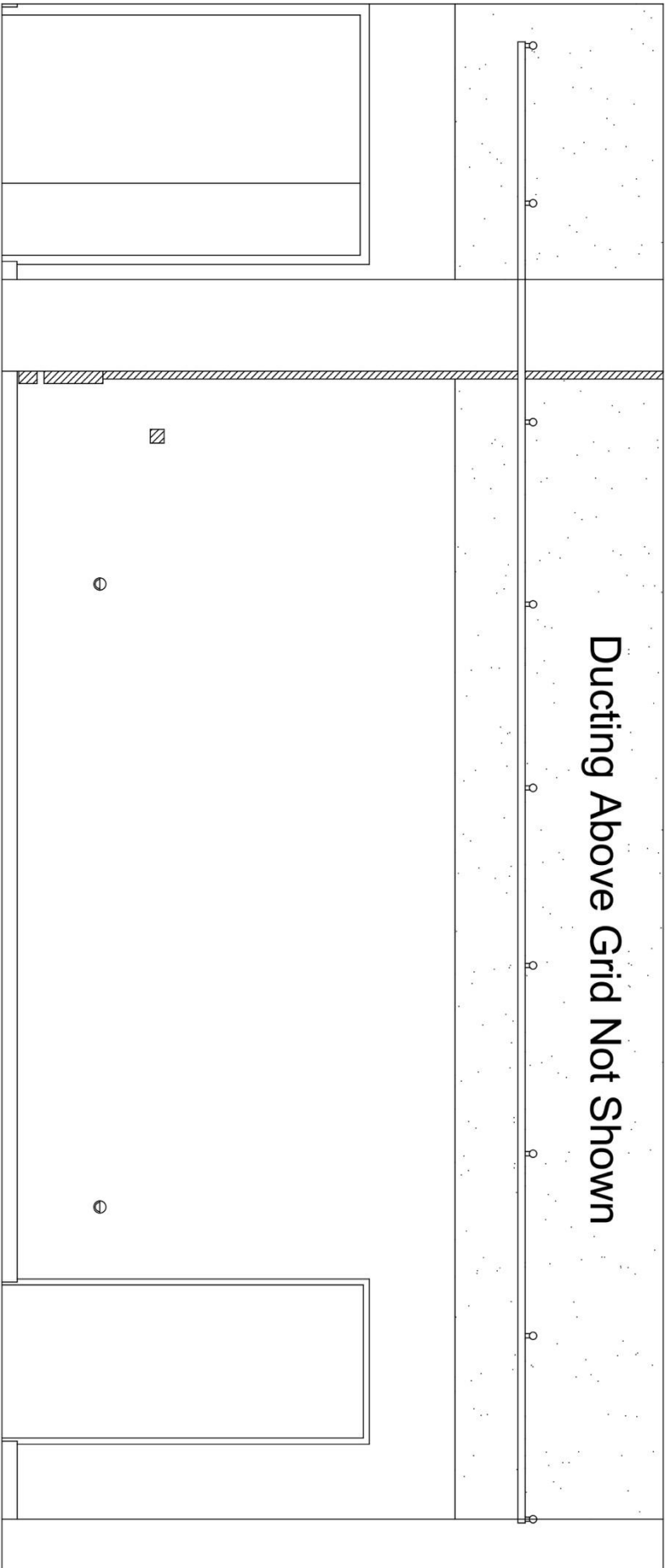

Ducting Above Grid Not Shown

